



[CLICK for More Info Online](#)

TrueCenter™ Pivot Socket Adjustable Strut Rods



Our adjustable length strut rods with TrueCenter™ pivot socket are the only product available that maintains correct suspension geometry without the increased resistance found with rubber and polyurethane bushings. The pivot stud features concentric bearing contact surfaces, 13/16" hex and a caster adjustment range of 3-4 degrees, depending upon application. This unique concentric arrangement avoids compromising the suspension geometry; unavoidable when using a standard rod end and clevis mounting method. A maximum of 12-degrees misalignment is possible in any direction and allows the strut rod to rotate beyond the limits of a standard rod end. High-strength, non-compressible, polymer bearing races create a low friction pivot center with zero deflection and can be lubricated through the easily accessible zerk fitting. The threaded retaining ring maintains preload on the pivot assembly and is secured with a locking set screw. Steel housings have vehicle specific mounting bosses and feature a knurled mounting surface for spin-free installation. A common 1/2" square drive is used to install the backup nut with a button head 'jam' fastener securing the assembly at the factory mounting location. Each strut rod is constructed of 1 x .156" wall steel tubing with direct threads to the pivot stud. A broad crimped end is robotic spray-arc welded to a 5/16" steel control arm adapter plate with integral steering stop. Adapter plate holes are slotted to achieve the correct mounting angle as caster adjustments are made.

Features

- TrueCenter™ pivot socket maintains correct axis and length of lower arm assembly
- Low friction polymer bearing races provide linear resistance, leaving spring rate unaffected for improved suspension tuning
- Adds 3-4 degrees of caster adjustment; includes vehicles with non-adjustable OEM strut rods
- Direct bolt-on installation to frame and factory or aftermarket lower control arm
- Completely serviceable for lubrication and free-play within the pivot assembly

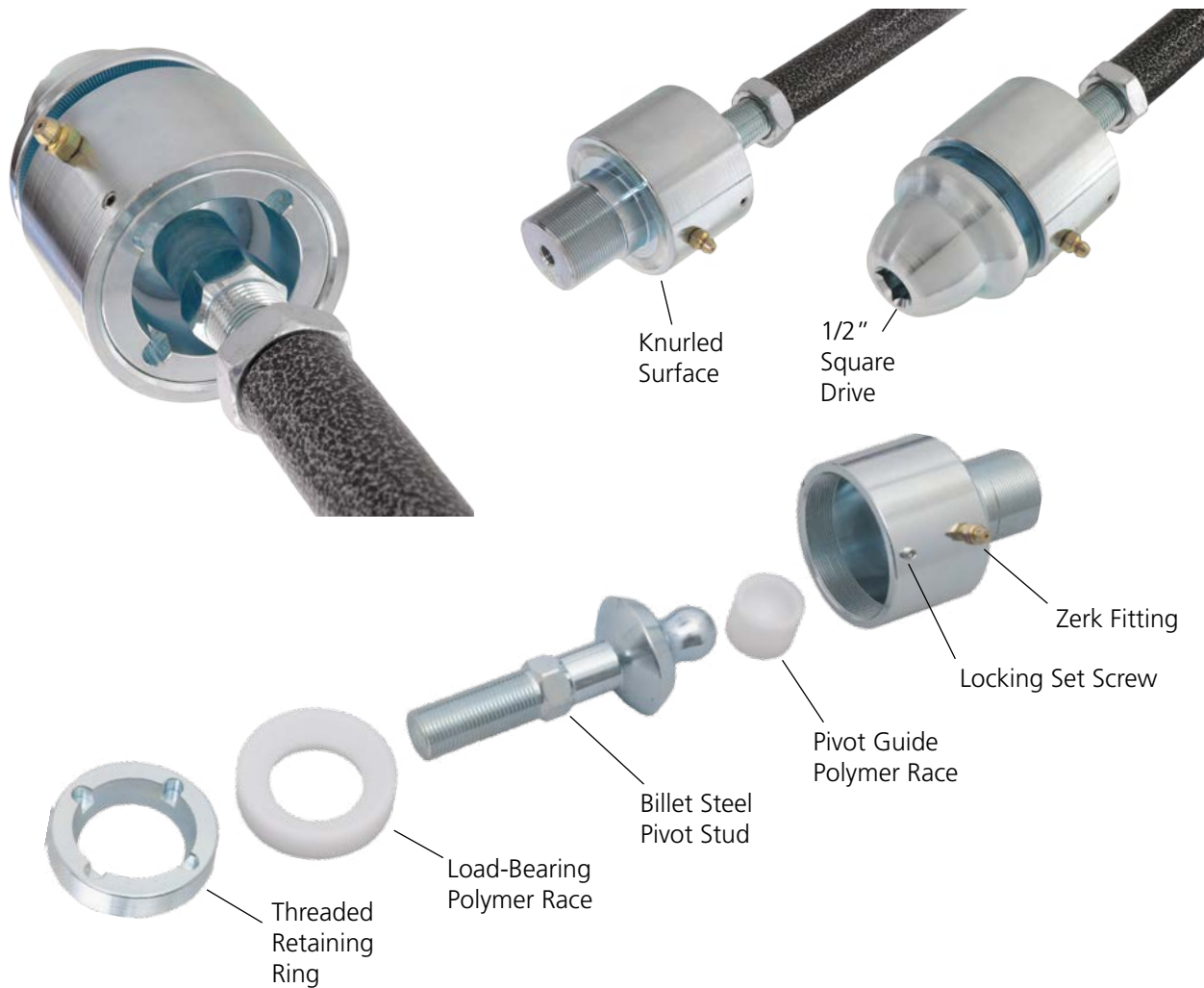

(Pivot ships assembled)

Make	Model	Year	Part Number
Ford	Fairlane	1966-1967	TCP STRD-06
		1968-1971	TCP STRD-07
	Falcon	1960-1965	TCP STRD-05
		1966-1967	TCP STRD-06
		1968-1970	TCP STRD-07
	Maverick	1970-1977	TCP STRD-07
	Mustang	1964-1966	TCP STRD-05
		1967	TCP STRD-06
		1968-1973	TCP STRD-07
	Ranchero	1960-1965	TCP STRD-05
		1966-1967	TCP STRD-06
1968-1971		TCP STRD-07	
Torino	1968-1971	TCP STRD-07	

Make	Model	Year	Part Number
Mercury	Comet	1960-1965	TCP STRD-05
		1966-1967	TCP STRD-06
		1971-1977	TCP STRD-07
	Cougar	1967	TCP STRD-06
		1968-1973	TCP STRD-07
	Cyclone	1964-1965	TCP STRD-05
		1966-1967	TCP STRD-06
		1968-1971	TCP STRD-07
	Montego	1968-1971	TCP STRD-07

All prices subject to change. Current pricing available at www.cachassisworks.com.



Total Control Products
 8661 Younger Creek Drive - Sacramento, CA 95828
 A Chris Alston's Chassisworks, Inc. Brand

Order: 800-722-2269
 Tech: 916-388-0288
 Fax: 916-388-0295

tcpsales@cachassisworks.com
tcptech@cachassisworks.com
www.totalcontrolproducts.com