

READ ALL INSTRUCTIONS COMPLETELY AND THOROUGHLY UNDERSTAND THEM BEFORE DOING ANYTHING.  
CALL TOTAL CONTROL PRODUCTS TECH SUPPORT (916) 388-0288 IF YOU NEED ASSISTANCE.

# INSTALLATION GUIDE

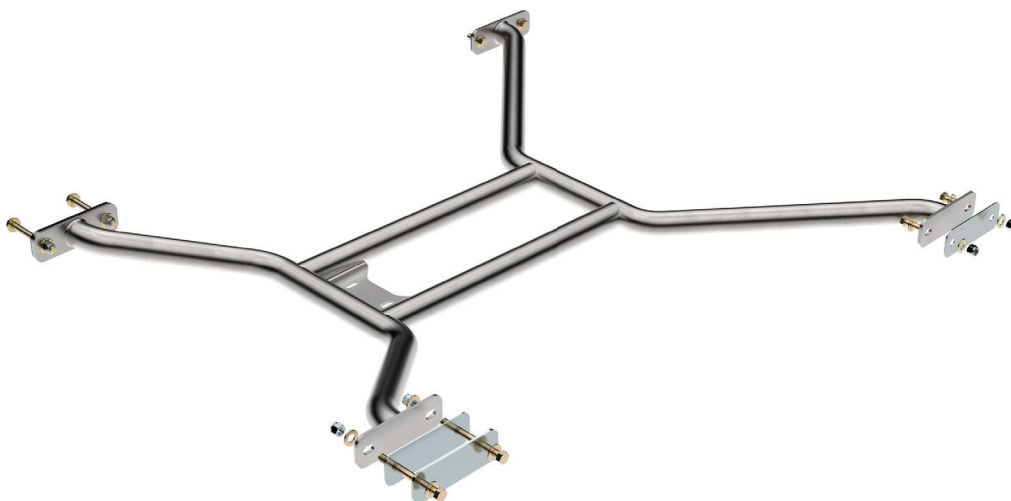

## TCP SUBCS-04 Torque Arm Center Support (Hardtop Models) 1960-65 Falcon, Comet, Ranchero



**Description:** Bolt-in subframe center support connects left and right weld-in subframe connectors

**Applications:** Falcon '60-65, Comet '60-65 and Ranchero '60-65

**Notes:**

- Installation of TCP SUBFC-03 weld-in subframe connectors required
- Modification to exhaust may be required for clearance
- Due to the age and large variations in these vehicles, it may be necessary to narrow the center support by cutting away the mounting tabs and shortening the bent cross-tube, before re-welding.

ITEM	QTY	PART NO.	DESCRIPTION
1	1	7962-5108	CENTER SUPPORT WELDMENT, $\varnothing$ 1 5/8 TUBE, 1960-65 FORD FALCON
2	1	7962-5096	SUBFRAME CONNECTOR, DRIVER, 1960-65 FORD FALCON
3	1	7962-5097	SUBFRAME CONNECTOR, PASSENGER, 1960-65 FORD FALCON
4	1	7908-061	ADJUSTER BRACKET, 1 1/4, DRIVESHAFT LOOP, TCP
5	1	7959-0268	DRIVESHAFT LOOP WELDMENT, 5.00 OD x 2.00 WIDE x .250
6	24	3120-038S-Y	FLAT WASHER, 3/8 SAE, HARDENED, YELLOW ZINC
7	6	3100-038C1.25Y	HEX BOLT, 3/8-16 x 1 1/4, GRADE 8, YELLOW ZINC
8	12	3101-038-16C	LOCKNUT 3/8-16, GRADE 5, NYLON INSERT, CLEAR ZINC
9	2	3100-038C1.00Y	HEX BOLT, 3/8-16 x 1, GRADE 8, YELLOW ZINC
10	4	3100-038C3.75Y	HEX BOLT, 3/8-16 x 3 3/4, GRADE 8, YELLOW ZINC
11	4	7908-058	SHIM, 1/16 CENTER SUPPORT, TCP
12	2	7908-062	SHIM, 10 GA CENTER SUPPORT, TCP

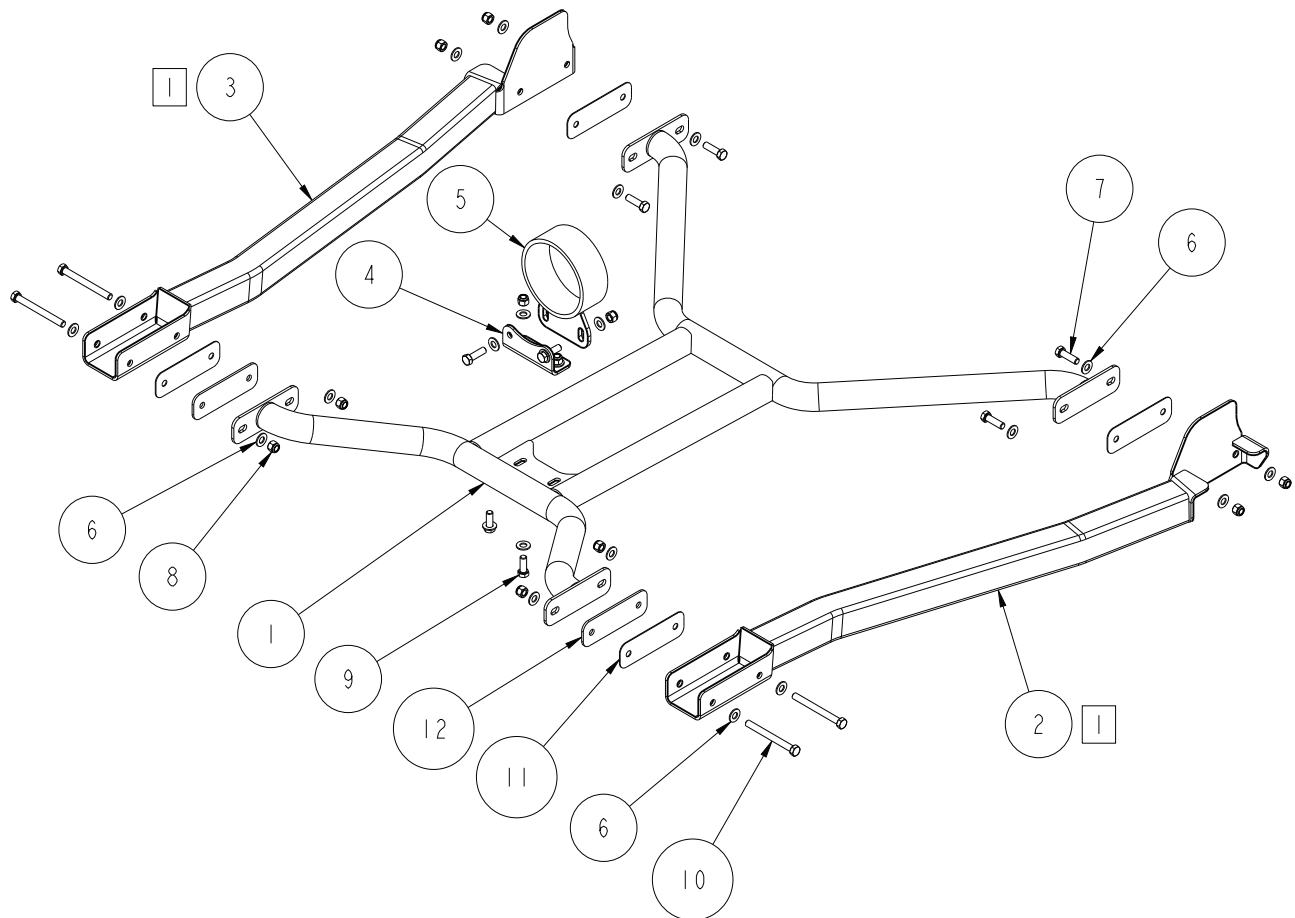

NOTES:  
 1 NOT INCLUDED

DESCRIPTION		PART NO.	
<b>CENTER SUPPORT, BOLT-IN, HARDTOP, 1960-65 FALCON, COMET, RANCHERO</b>		<b>TCP SUBCS-04</b>	
<i>Chris Alston's CHASSISWORKS INC.</i> 8661 YOUNGER CREEK DRIVE SACRAMENTO, CA 95828 (916) 388-0288 FAX 388-0295		3/13/23	DWG: TCP_SUBCS-04

# PARTS LIST

## TCP SUBCS-04 - Torque Arm Center Support '60-65 Falcon

Qty	Part Number	Description
1	7962-5108	Center support weldment hardtop
1	7918-077	Hardware Bag

### 7918-077 - Hardware Bag

4	3100-038C1.25Y	Bolt 3/8-16 x 1-1/4" hex head cap screw
4	3100-038C3.75Y	Bolt 3/8-16 x 3-3/4" hex head cap screw (use with TCP SUBFC-03)
8	3101-038-16C	Locknut 3/8-16 nylon insert
16	3120-038S-Y	Washer 3/8 hardened flat SAE
4	7908-058	Center support shin 1/16" thick
2	7908-062	Center support shin 1/8" thick

## INSTRUCTIONS

*NOTE: A 1965 Mustang with TCP SUBCS-01 is shown in the following images and may show slight differences from the Falcon platform. The installation procedure is identical.*

1. The weld-in subframe connectors (TCP SUBFC-03) must be installed before proceeding.
2. Raise and safely support the vehicle with the subframe connectors unobstructed and with enough room to work underneath.
3. Measure the distance between the insides of the subframe connector front cups. The minimum distance required to mount the bolt-in center support is 25-5/8". If the measurement is less than 25-5/8", use a mallet and wooden block to increase the distance.
4. **Exhaust Modification:**  
If the exhaust is currently installed on the vehicle, test fit the center support to check for clearance. If the center support does not clear, the exhaust must be modified. There is sufficient room available with the center support installed to use long tube headers with 'H' or 'X' pipe and dual 3" exhaust.



5. Remove exhaust and proceed with installation. Center support must be installed during exhaust fabrication.
6. Using a 3/8" bit, drill through each side of the front frame rail using the forward box of the subframe connectors as a jig.



#### TCP SUBFC-03 (SHOWN)

- Check hole clearance by inserting the 3/8-16 x 3-3/4" mounting bolt through each of the four through holes.
- Place a flat washer over two of the long bolts.
- Raise the front of the center support into position and insert one bolt through subframe connector front cup and then through the center support tab.



#### REAR FRAME (SEE DIAGRAM)

- Use 3/8" x 1" bolts with flat washers. Apply Loctite® or similar threadlocker to threads.
7. Swing the center support up until the rear tabs are in line with frame connector brackets.



- Slide a flat washer onto the 3/8-1-1/4" hex bolts and insert them through the rear mount from the outside.



- If the side clearance between the center support and the subframe connectors is greater than 1/16", use the supplied shims.

- The shims can be easily installed by backing out one bolt at a time and inserting the shim.

- Once any necessary shims are in place, slide flat washers over the hex bolts followed by locknuts and tighten to 35 lb-ft.

- The installation is complete.



**WARRANTY NOTICE:**

There are NO WARRANTIES, either expressed or implied. Neither the seller nor manufacturer will be liable for any loss, damage or injury, direct or indirect, arising from the use or inability to determine the appropriate use of any products. Before any attempt at installation, all drawings and/or instruction sheets should be completely reviewed to determine the suitability of the product for its intended use. In this connection, the user assumes all responsibility and risk. We reserve the right to change specification without notice. Further, Chris Alston's Chassisworks, Inc., makes **NO GUARANTEE** in reference to any specific class legality of any component. **ALL PRODUCTS ARE INTENDED FOR RACING AND OFF-ROAD USE AND MAY NOT BE LEGALLY USED ON THE HIGHWAY.** The products offered for sale are true race-car components and, in all cases, require some fabrication skill. **NO PRODUCT OR SERVICE IS DESIGNED OR INTENDED TO PREVENT INJURY OR DEATH.**

Total Control Products  
A Chris Alston's Chassisworks, Inc. Brand  
8661 Younger Creek Drive  
Sacramento, CA 95828  
Phone: 916-388-0288  
Technical Support: [tcptech@cachassisworks.com](mailto:tcptech@cachassisworks.com)

